

Circulation Kit

310673 Rev.A

Part No. 248652

For use with ProMix™ Easy and Xtreme Mix™ 185 Proportioners, to circulate material from proportioner to fluid supply container

5000 psi (34.5 MPa, 345 bar) Maximum Fluid Working Pressure



Read warnings and instructions in the ProMix Easy operation manual 309908 or the Xtreme Mix 185 operation manual 310665.

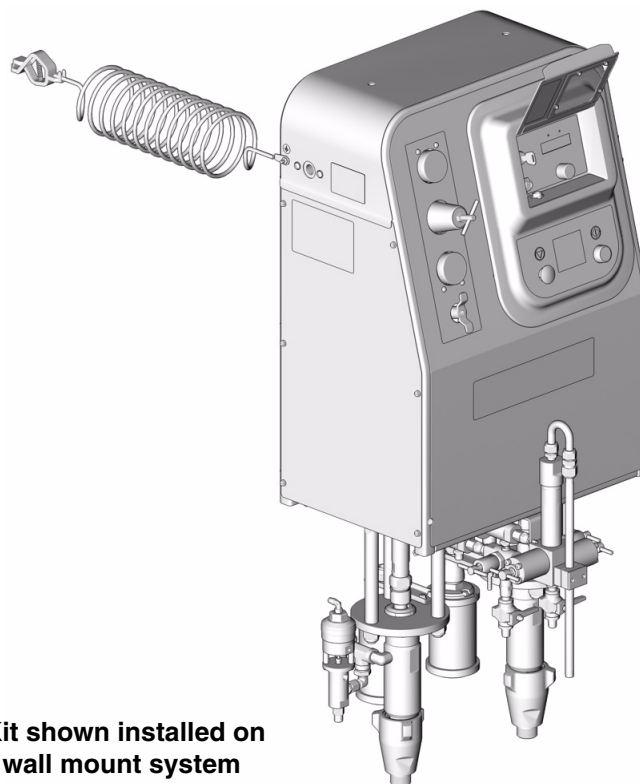

Circulation Kit shown installed on ProMix Easy wall mount system



TI5090a

PROVEN QUALITY. LEADING TECHNOLOGY.

Installation

Before Installing Kit

 Letters and numbers in parentheses refer to the callouts in the figures and the **Parts** list on page 7.



WARNING



To reduce the risk of serious injury including fluid injection, relieve the pressure as explained in the proportioner operation manual before disassembling any parts or installing the kit.

1. Relieve pressure (see proportioner operation manual).
2. Flush fluid system (see proportioner operation manual).

Install Dispense Valve

Xtreme Mix 185 Proportioners

 Apply thread sealant to all non-swivel threaded connections.

 Some kit parts are not used on the Xtreme Mix 185.

1. Remove plug from top of fluid filter (F). Install 1/4 npt elbow (7) in its place. See FIG. 1.
2. Install swivel (4) in side port of dispense valve (1).
3. Screw swivel (4) onto elbow (7). Adjust position of dispense valve as necessary.

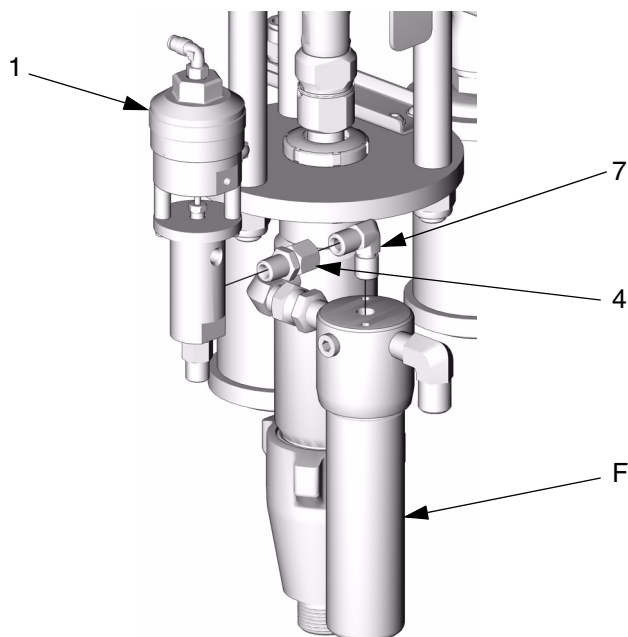

TI5095a

FIG. 1. Xtreme Mix 185

ProMix Easy Proportioners



Apply thread sealant to all non-swivel threaded connections.

1. Disconnect fluid line from pump fluid outlet. Remove outlet fitting (A). Keep fitting for use later.
2. Install 3/8 npt elbow (3) in pump outlet. See FIG. 2.
3. Screw tee (6) onto elbow (3). Branch of tee should point down.
4. Screw bushing (5) into branch of tee (6).
5. Screw 1/4 npt elbow (7) into bushing (5). Elbow should face forward.
6. Install swivel (4) in side port of dispense valve (1).
7. Screw swivel (4) onto elbow (7). Adjust position of dispense valve as necessary.
8. Screw pump outlet fitting (A) removed in step 1 into open port of tee (6).
9. Connect fluid line (B) to fitting (A).

Proportioners with HydraMix Pumps

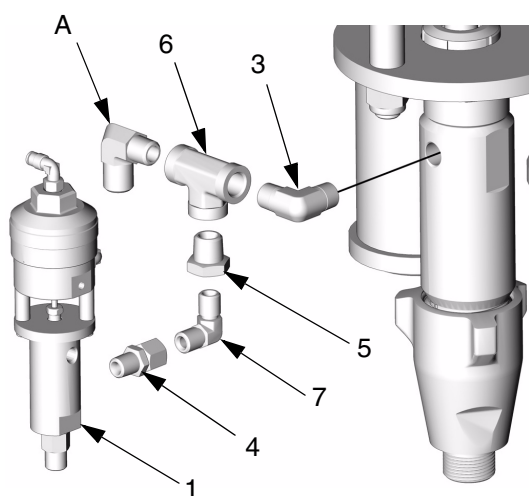

TI5093a

Proportioners with UltraMix Pumps

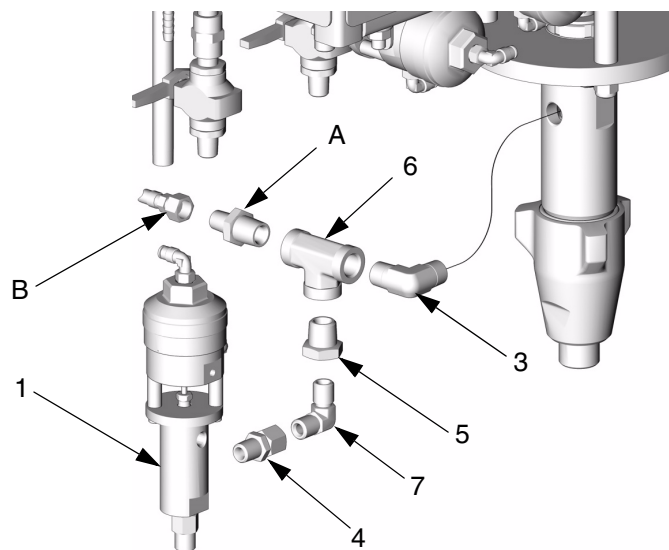

TI5094a

FIG. 2. ProMix Easy

Install Solenoid Valve

1. Close main air shutoff valve on air supply line and on proportioner.
2. Remove side panels (C). See FIG. 3.
3. Remove fasteners. Gently pull user interface (D) away from pneumatic control (E).
4. To completely remove user interface (D), disconnect ground wire (G), and wires from J1 and J2 on main board (K).

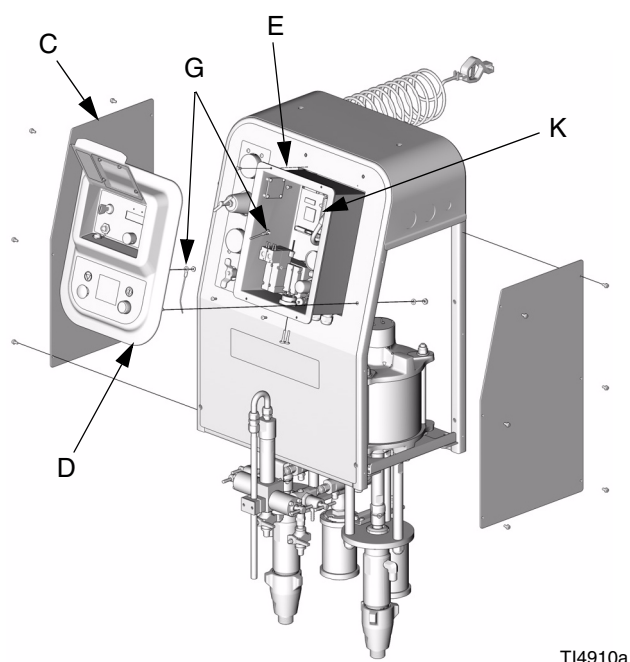

FIG. 3. Access Solenoid Module



Two solenoids are standard with the proportioner. If a third solenoid is already installed, skip steps 5-7 and go to **Connect Solenoid Lines**. Do not install a fourth solenoid; save an extra solenoid as a spare.

5. Remove two screws and take off cover plate (P) next to existing solenoids (L). See FIG. 4.
6. Install third solenoid (2) where plate had been. Secure with two screws.
7. Connect electrical plug to solenoid connector (N).

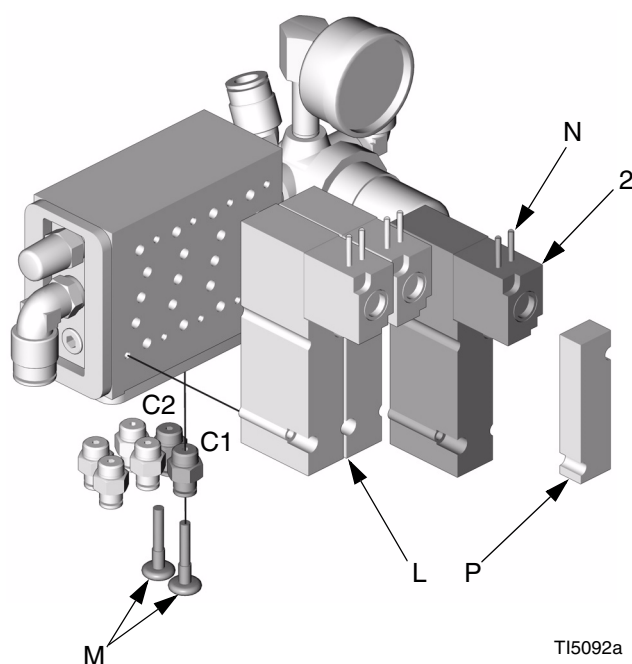

FIG. 4. Install Solenoid Valve

Connect Solenoid Lines

1. Remove plugs (M) from solenoid ports C1 and C2. See FIG. 4.
2. Connect clear tubing (8) between solenoid “open” port (C2) and tube fitting (C2) on dispense valve (1). See FIG. 5.
3. Connect black tubing (9) between solenoid “close” port (C1) and tube fitting (C1) on dispense valve (1).



If two kits are being installed, use the Y-connectors (10) to supply air to the second dispense valve. The Y-connectors may be installed at the solenoid ports or at the tube fittings of the first dispense valve.

4. Reassemble user interface in reverse order, see page 4.

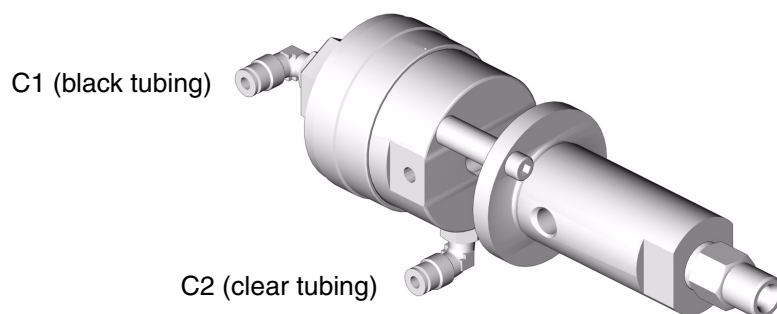



TI4608a

FIG. 5. Tubing Connections

Connect Return Line

**WARNING**



Use only high pressure return hoses rated to withstand the maximum working pressure of the proportioner. See proportioner operation manual.

Operation

To operate the proportioner in recirculation mode, see the proportioner operation manual.

1. Connect the return hose (R, not supplied) to the dispense valve (1) outlet. See FIG. 6.
2. Place the other end of the return hose in the fluid supply container (T).

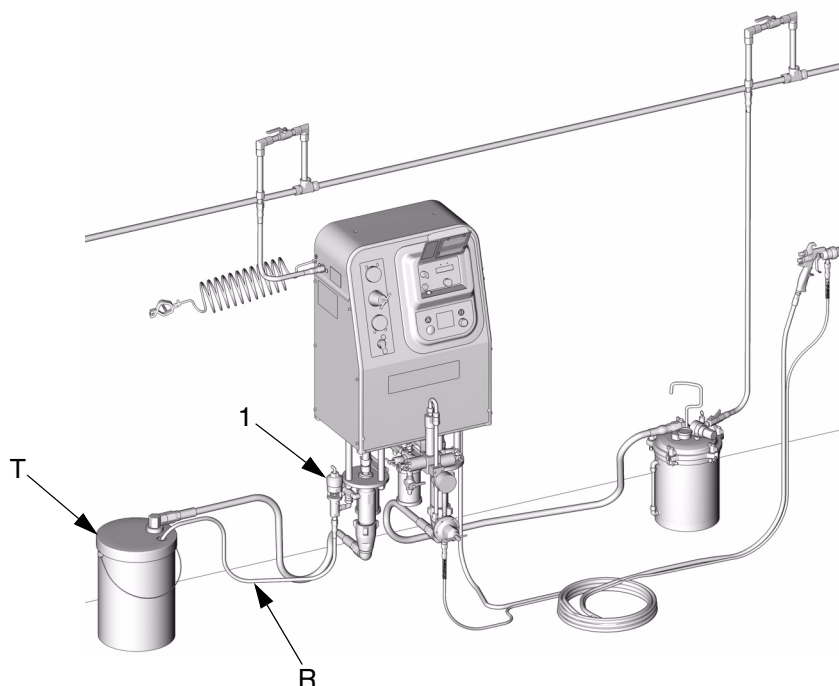

TI5091a

FIG. 6. Completed Installation (ProMix Easy Shown)

Parts

Ref. No.	Part No.	Description	Qty.	Ref. No.	Part No.	Description	Qty.
1	287222	VALVE, dispense; see 310655	1	6	15E274	TEE; 3/8 npt(f); sst	1
2	552180	VALVE, solenoid; 12 Vdc	1	7	114342	ELBOW; 1/4 npt(m); sst	1
3	15E279	ELBOW; 3/8 npt(m); sst	1	8	598095	TUBE, clear; nylon; 5/32 in. (4 mm) OD	2.5 ft
4	114339	UNION, swivel; 1/4 npsm(f) x 1/4 npt(m); sst	1	9	054753	TUBE, black; nylon; 5/32 in. (4 mm) OD	2.7 ft
5	168160	BUSHING, pipe; 1/4 npt(f) x 3/8 npt(m); sst	1	10	198175	Y-CONNECTOR, push-in tube; 5/32 (4 mm) OD tube	2

Graco Standard Warranty

Graco warrants all equipment referenced in this document which is manufactured by Graco and bearing its name to be free from defects in material and workmanship on the date of sale by an authorized Graco distributor. With the exception of any special, extended, or limited warranty published by Graco, Graco will, for a period of twelve months from the date of sale, repair or replace any part of the equipment determined by Graco to be defective. This warranty applies only when the equipment is installed, operated and maintained in accordance with Graco's written recommendations.

This warranty does not cover, and Graco shall not be liable for general wear and tear, or any malfunction, damage or wear caused by faulty installation, misapplication, abrasion, corrosion, inadequate or improper maintenance, negligence, accident, tampering, or substitution of non-Graco component parts. Nor shall Graco be liable for malfunction, damage or wear caused by the incompatibility of Graco equipment with structures, accessories, equipment or materials not supplied by Graco, or the improper design, manufacture, installation, operation or maintenance of structures, accessories, equipment or materials not supplied by Graco.

This warranty is conditioned upon the prepaid return of the equipment claimed to be defective to an authorized Graco distributor for verification of the claimed defect. If the claimed defect is verified, Graco will repair or replace free of charge any defective parts. The equipment will be returned to the original purchaser transportation prepaid. If inspection of the equipment does not disclose any defect in material or workmanship, repairs will be made at a reasonable charge, which charges may include the costs of parts, labor, and transportation.

THIS WARRANTY IS EXCLUSIVE, AND IS IN LIEU OF ANY OTHER WARRANTIES, EXPRESS OR IMPLIED, INCLUDING BUT NOT LIMITED TO WARRANTY OF MERCHANTABILITY OR WARRANTY OF FITNESS FOR A PARTICULAR PURPOSE.

Graco's sole obligation and buyer's sole remedy for any breach of warranty shall be as set forth above. The buyer agrees that no other remedy (including, but not limited to, incidental or consequential damages for lost profits, lost sales, injury to person or property, or any other incidental or consequential loss) shall be available. Any action for breach of warranty must be brought within two (2) years of the date of sale.

GRACO MAKES NO WARRANTY, AND DISCLAIMS ALL IMPLIED WARRANTIES OF MERCHANTABILITY AND FITNESS FOR A PARTICULAR PURPOSE, IN CONNECTION WITH ACCESSORIES, EQUIPMENT, MATERIALS OR COMPONENTS SOLD BUT NOT MANUFACTURED BY GRACO. These items sold, but not manufactured by Graco (such as electric motors, switches, hose, etc.), are subject to the warranty, if any, of their manufacturer. Graco will provide purchaser with reasonable assistance in making any claim for breach of these warranties.

In no event will Graco be liable for indirect, incidental, special or consequential damages resulting from Graco supplying equipment hereunder, or the furnishing, performance, or use of any products or other goods sold hereto, whether due to a breach of contract, breach of warranty, the negligence of Graco, or otherwise.

FOR GRACO CANADA CUSTOMERS

The Parties acknowledge that they have required that the present document, as well as all documents, notices and legal proceedings entered into, given or instituted pursuant hereto or relating directly or indirectly hereto, be drawn up in English. Les parties reconnaissent avoir convenu que la rédaction du présente document sera en Anglais, ainsi que tous documents, avis et procédures judiciaires exécutés, donnés ou intentés, à la suite de ou en rapport, directement ou indirectement, avec les procédures concernées.

Graco Information

TO PLACE AN ORDER, contact your Graco distributor or call to identify the nearest distributor.

Phone: 612-623-6921 **or Toll Free:** 1-800-328-0211, **Fax:** 612-378-3505

*All written and visual data contained in this document reflects the latest product information available at the time of publication.
Graco reserves the right to make changes at any time without notice.*

Sales Office: Minneapolis
International Offices: Belgium, Korea, Hong Kong, Japan
GRACO INC. P.O. BOX 1441 MINNEAPOLIS, MN 55440-1441
www.graco.com
Printed in USA 310673A

04/2004