

# Repair - Parts List



## TexSpray GTX™ 2000

US Patents D502,532; D580,517 S; and 7,114,664

309916K

**- For Water-Based Materials Only -**

### Model: 248082

**Sprayer with Graco Trigger Gun**

120 psi (8.27 bar) Maximum Working Air Pressure

120 psi (8.27 bar) Maximum Working Fluid Pressure

### Model: 248083

**Sprayer with Graco Flex Gun**

120 psi (8.27 bar) Maximum Working Air Pressure

120 psi (8.27 bar) Maximum Working Fluid Pressure

### Model: 248084

**Sprayer with Graco Pole Gun**

120 psi (8.27 bar) Maximum Working Air Pressure

120 psi (8.27 bar) Maximum Working Fluid Pressure



#### Important Safety Instructions

Read all warnings and instructions in this manual.  
Save these instructions.

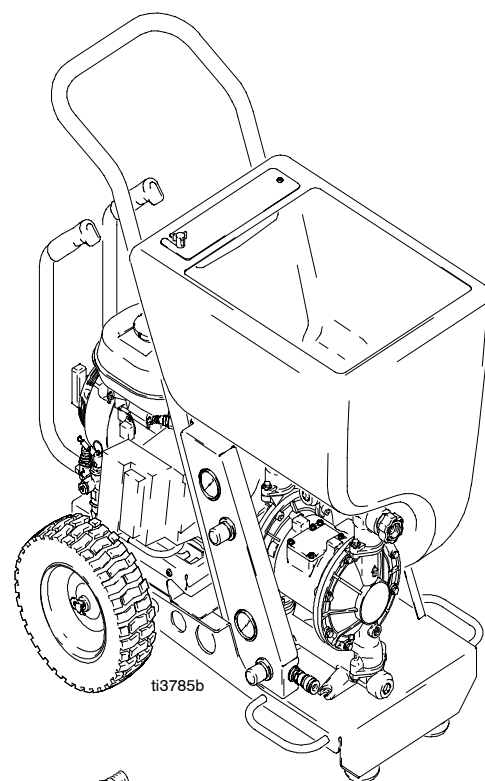

Model 248082 Shown

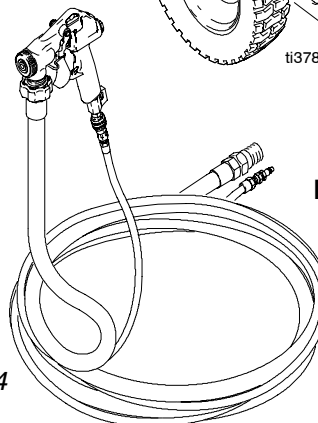

#### Related Manuals:

Pump: 308479

Gun: 310616 model 248082  
308603 model 248083 and 248084

Operation: 309915 English

PROVEN QUALITY. LEADING TECHNOLOGY.



# Table of Contents

Warnings .....	2	Parts Drawing .....	21
Component Identification and Function .....	4	Parts List .....	20
Pump Maintenance .....	10	Technical Data .....	26
Troubleshooting .....	18	Graco Warranty .....	28
Removing and Inspecting Cooler .....	13	Graco Phone Number .....	28

## Symbols

### Warning Symbol



This symbol alerts you to the possibility of serious injury or death if you do not follow the instructions.

### Caution Symbol



Alerts you to the possibility of damage to or destruction of equipment if you do not follow the instructions.

**The following are general warnings related to the safe setup, use, maintenance and repair of this equipment. Additional, more specific warnings may be found throughout the text of this manual where applicable.**

## WARNING



### Fire and Explosion Hazard

Flammable fumes, such as solvent and paint fumes, in work area can ignite or explode. To help prevent fire and explosion:

- Use equipment in well ventilated areas only.
- Do no fill fuel tank while motor is running or hot; shut off motor and let it cool. Fuel is flammable and can ignite or explode if spilled on hot surface.
- Eliminate all ignition sources; such as pilot lights, cigarettes, portable electric lamps, and plastic drop cloths (potential static arc).
- Keep the work area free of debris, including solvent, rags, and gasoline.
- Do not plug or unplug power cords or turn lights on or off when flammable fumes are present.

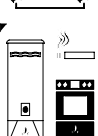

### Carbon Monoxide Hazard

Exhaust contains poisonous carbon monoxide, which is colorless and odorless. Breathing carbon monoxide can cause death. Do not operate in an enclosed area.







### Equipment Misuse Hazard

Equipment misuse can cause death or serious injury.

- Do not exceed the maximum working pressure or temperature rating of the lowest rated system component. See **Technical Data** in all equipment manuals.
- Use fluids and solvents that are compatible with equipment wetted parts. See **Technical Data** in all equipment manuals. Read fluid and solvent manufacturer's warnings.
- Check equipment daily. Repair or replace worn or damaged parts immediately.
- Do not alter or modify this equipment.
- Use the equipment only for its intended purpose. Call your Graco distributor for information.
- For professional use only.
- Route hoses away from traffic areas, sharp edges, moving parts, and hot surfaces.
- Do not use hoses to pull equipment.
- Comply with all applicable safety regulations.

# ! WARNING

	<p><b>Burn Hazard</b></p> <p>Equipment surfaces and fluid that is heated can become very hot during operation. To avoid severe burns, do not touch hot fluid or equipment. Wait until equipment/fluid has cooled completely.</p>
	<p><b>Pressurized Equipment Hazard</b></p> <p>Compressed air can inject in skin. Air tubing rupture can cause injury if disconnect while under pressure. To reduce risk of injury:</p> <ul style="list-style-type: none"> <li>• Never exceed maximum working pressure of any attachment</li> <li>• Do not direct air stream at body</li> <li>• Follow <b>Pressure Relief Procedure</b>, page 6 whenever you are instructed to relieve pressure, stop spraying, service equipment, install or clean spray nozzle or disconnect or connect hose.</li> </ul>
	<p><b>Cleaning Solvent with Plastic Parts Hazard</b></p> <p>Use only compatible solvents to clean plastic structural or pressure-containing parts. Many solvents can degrade plastic parts to the point where they could fail. Such failure could cause serious injury or property damage. See the <b>Technical Data</b> section on page 26 in this instruction manual and in all other equipment manuals. Read the fluid and solvent manufacturer's warnings.</p>
	<p><b>Personal Protective Equipment</b></p> <p>Wear appropriate protective equipment when operating, servicing, or when in the operating area of this equipment to help protect yourself from serious injury, including eye injury, inhalation of toxic fumes, burns and hearing loss. This equipment includes, but is not limited to:</p> <ul style="list-style-type: none"> <li>• protective eye wear</li> <li>• clothing and respirator as recommended by fluid and solvent manufacturer</li> <li>• hearing protection</li> <li>• gloves</li> </ul>

## CAUTION

Water or material remaining in unit when temperatures are **below freezing** can damage pump and/or delay startup.

To insure water and material are completely drained out of unit:

- Remove material line from sprayer
- Tip sprayer to allow material (water) to flow out of pump inlet.

Before adding material or starting unit in cold weather, run warm water through pump.

# Component Identification

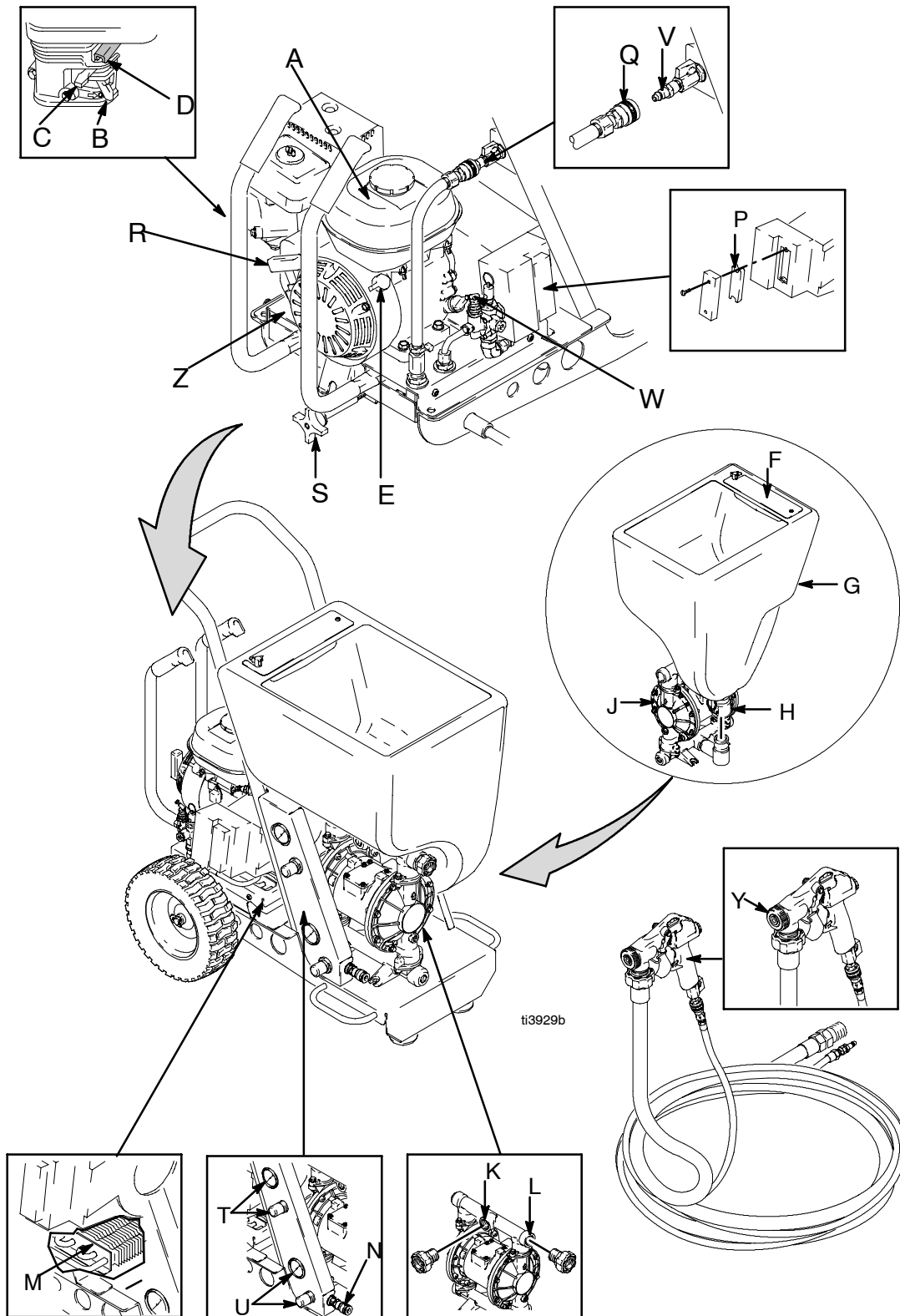

# Component Identification

**Note:** Letters A-Z used in the chart below to identify specific components, will also be used throughout the text of this manual to identify those components.

	English
A	Gas Tank
B	Fuel Valve
C	Choke
D	Throttle Lever
E	Engine ON/OFF Switch
F	Nozzle Storage
G	Hopper
H	Hopper Quick Connect
J	Diaphragm Pump
K	Material Outlet Option 1
L	Material Outlet Option 2
M	Air Cooler
N	Gun Air Outlet Quick Connect
P	Air Filter (both sides)
Q	Air Line Quick Connect
R	Engine Starter Cord
S	Motor Lock Knob
T	Material (Pump) Air Pressure Gage and Control Knob
U	Gun Air Pressure Gage and Control Knob
V	Sprayer Quick Connect Air In and Air ON/OFF Valve
W	Pressure Unloader
Y	Gun (see manual 308878)*
Z	Compressor Power Pack

*\*Reference numbers used in gun illustrations throughout this manual, coincide with reference numbers used in gun manual 308878*

# Preparation



## Pressure Relief Procedure

1. Turn engine ON/OFF switch (E) OFF.
2. Open gun air valve (23).
3. Trigger gun, and spray material back into hopper.

## Removing and Installing the Hopper

The hopper (G) can be removed from the cart for cleaning and servicing equipment.

**NOTE:** Before removing hopper, allow unit to cool down and/or remove compressor power pack from cart.

### Removing Hopper

1. To remove hopper (G), release the latches on each side of coupler (H).
2. Lift hopper straight up, off unit. See Fig. 1.

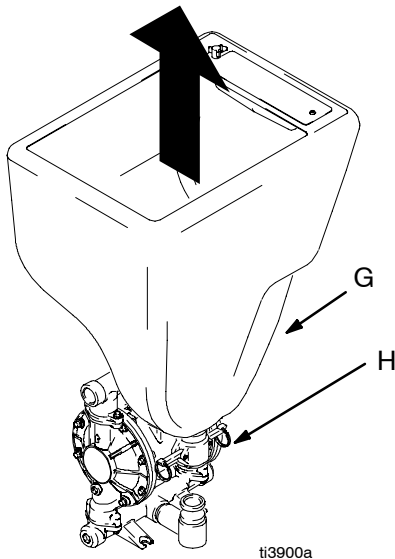

Fig. 1

### Installing Hopper

1. To install hopper, position coupler over material outlet and slide it straight down, over the fitting, as far as it will go.
2. Secure latches by pushing each one up and firmly into locked position. See Fig. 2.

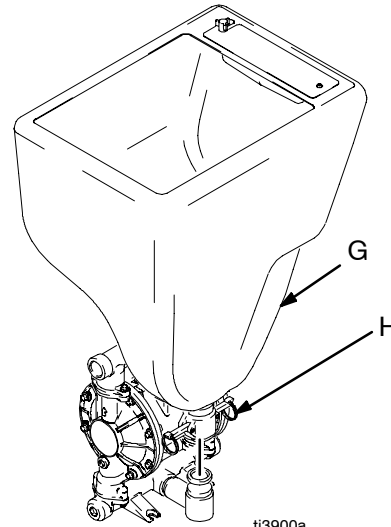



Fig. 2

# Preparation

## Removing and Installing the Compressor Power Pack

**! WARNING**

  
Page 3

  
Page 6

When servicing equipment it may be necessary to remove the Compressor Power Pack (Z) from the cart.

### Removing Compressor Power Pack:

1. Disconnect air line quick connect fitting (Q) from compressor air quick connect fitting (V). See Fig 3.

**NOTE:** Quick connect fitting will become hot during operation, see Burn Hazard, page 3.

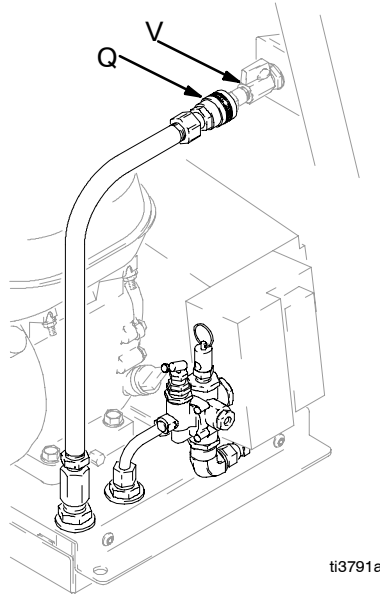

**Fig. 3**

2. Loosen knob (S) by turning it counter-clockwise, relieving tension on the bracket. See Fig. 4.

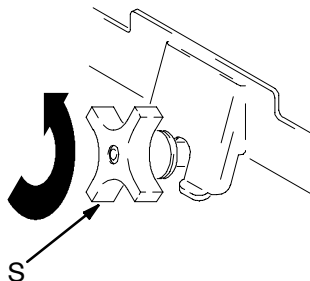

**Fig. 4**

3. Push knob down. See Fig. 4.

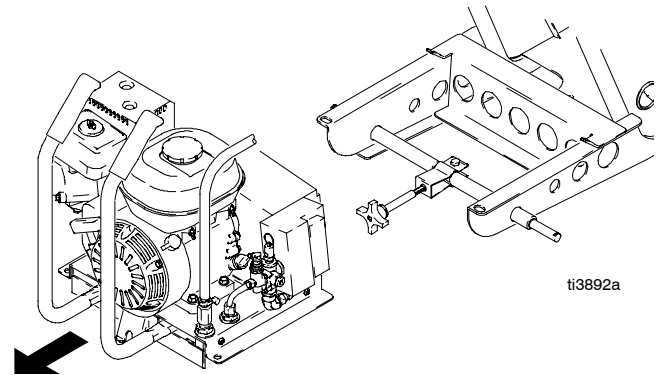

**Fig. 5**

4. The Compressor Power Pack (Z) slides off back of cart. See Fig 5.

### Installing Compressor Power Pack:

1. Disconnect one end of air hose from air line quick connect fitting (Q) and the other end of the air hose from compressor air quick connect inlet fitting (V).
2. Inspect cart and compressor power pack (Z). Remove any debris or dirt.
3. Using handles, lift compressor power pack (Z) onto cart frame.

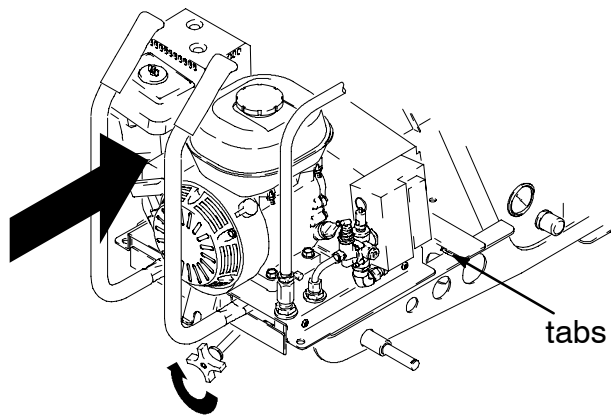

Fig. 6

4. Slide Compressor Power Pack (Z) forward until front edge meets tabs. Fig. 6.
5. Lift and turn motor lock knob (S) until Compressor Power Pack (Z) is securely attached to the cart.
6. Attach air line quick connect fitting (Q) to compressor air quick connect fitting (V) Fig 7.

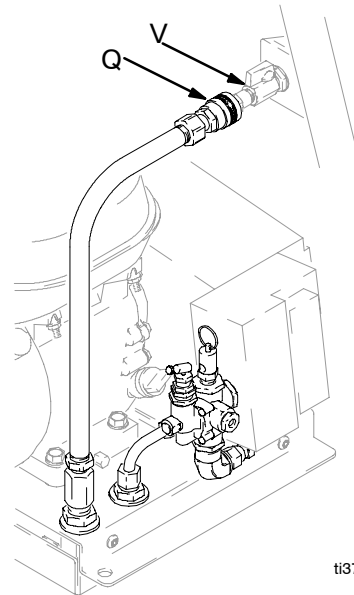

Fig. 7



# Engine Maintenance

## Changing Engine Oil



1. **Relieve Pressure**, page 6.
2. Remove compressor power pack, page 7.
3. Place a suitable container to catch the used oil below the compressor power pack.
4. Remove drain bolt and filler cap/dip stick. Fig. 8.

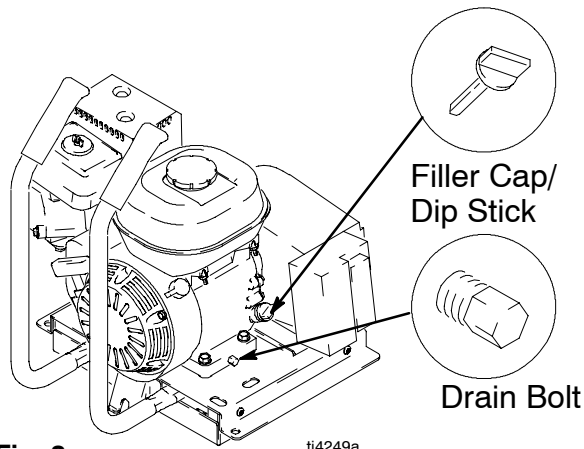

**Fig. 8**

ti4249a

5. Tip unit to drain the used oil out of unit. Fig. 9. .

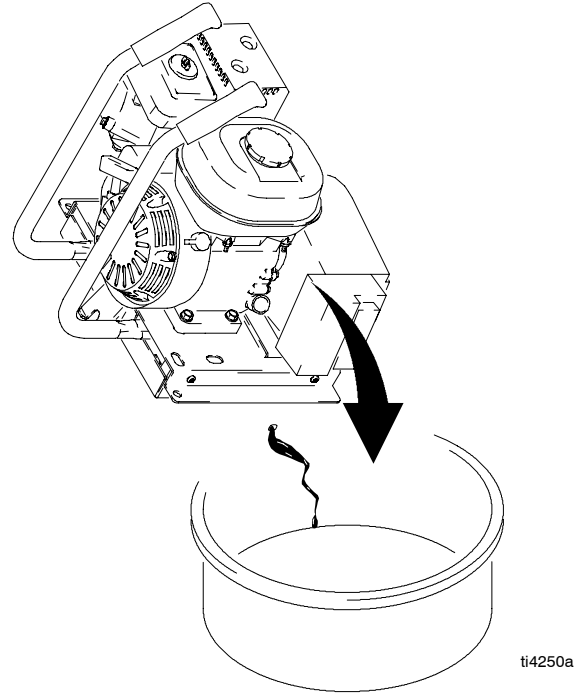

ti4250a

**Fig. 9**

6. Reinstall drain bolt. Tighten securely. Fig. 8.
  7. Place the compressor power pack on a level surface. Fill to the outer edge of the oil filler hole with SAE 10W-30 oil. The engine oil capacity is 0.63 qt (0.60 liters). (Refer to the Honda Engines Owner's Manual for recommended oil weight.)
  8. Reinstall the filler cap/dip stick. Tighten securely.
- NOTE:** Running engine with a low oil level can cause engine damage. The Oil Alert® system will automatically stop the engine before the oil level falls below the safe limit. However, to avoid the inconvenience of an unexpected shutdown, fill to the upper limit and check oil level regularly.
9. Reinstall compressor power pack on sprayer, page 8.

For all other engine maintenance, troubleshooting, and repair, see Honda Engines Owner's Manual.

# Pump Maintenance

For pump maintenance, troubleshooting, and repair, see diaphragm pump instruction manual 308479. A parts list and illustration for the pump is also included in this manual.

# Removing and Installing Pump

## ⚠ WARNING



Page 6

### Removing Pump

1. **Relieve Pressure**, page 6.
2. Remove hopper, page 6.
3. Disconnect air lines. Fig. 10.

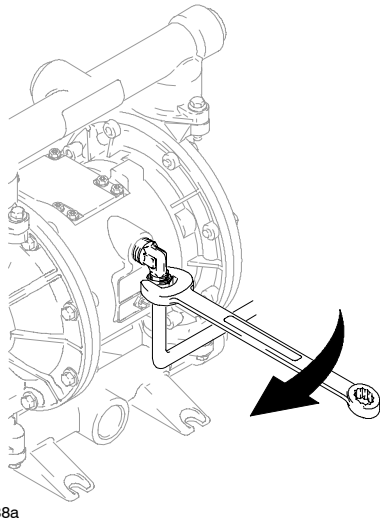

Fig. 10

4. Disconnect exhaust tube. Fig. 11.

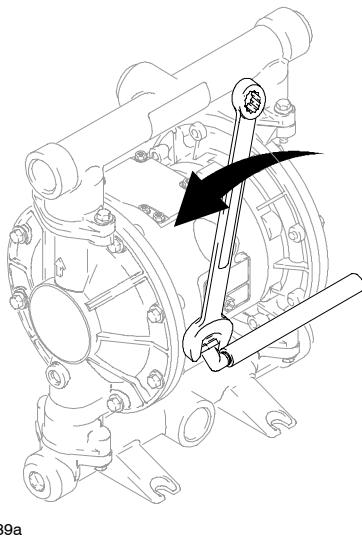

Fig. 11

5. Remove 4 bolts holding pump to cart. Fig. 12.

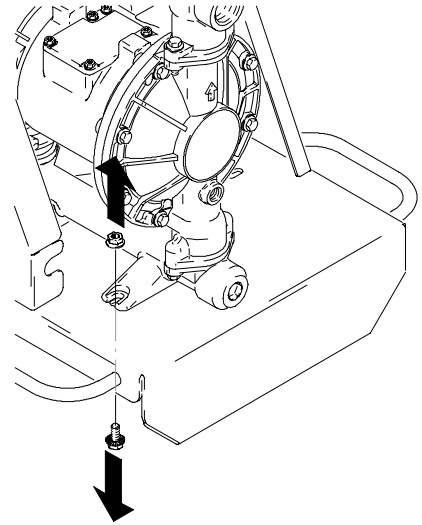

Fig. 12

6. Lift pump straight up off cart. Fig. 13.

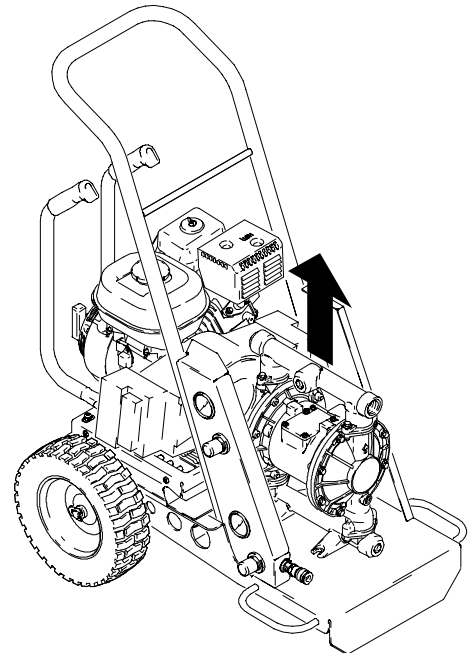

Fig. 13

### Installing Pump

1. Lower pump on cart.
2. Replace 4 bolts holding pump to cart.
3. Reconnect exhaust tube.
4. Reconnect air lines.
5. Replace hopper, page 6.

# Removing and Installing Unloader Valve

## **WARNING**



Pages 2 and 6

## Removing Unloader Valve

1. **Relieve Pressure**, page 6.
2. Remove air line at compression fitting. Fig. 14.

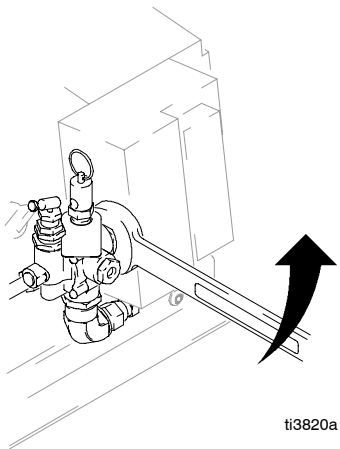

**Fig. 14**

3. Remove right angle fitting. Fig. 15.

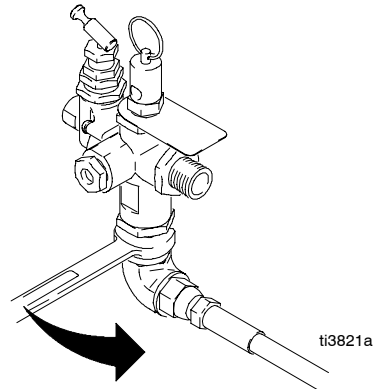

**Fig. 15**

4. Remove safety valve.
5. Unscrew unloader valve and remove from fitting. Fig. 16.

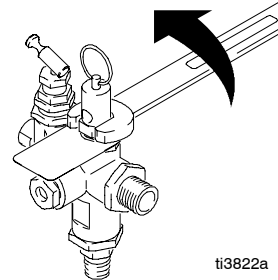

**Fig. 16**

## Installing Unloader Valve

1. Replace unloader valve. Use thread sealant to obtain a good seal.
2. Replace safety valve.
3. Replace right angle fitting.
4. Replace compression fitting.

# Removing and Installing Cooler



## Removing Cooler

1. **Relieve Pressure**, page 6.
2. Remove Compressor Power Pack (Z) , page 7.
3. Remove 2 air lines (ee) Fig 17.
4. Remove 2 bulk head nuts. Fig. 17.

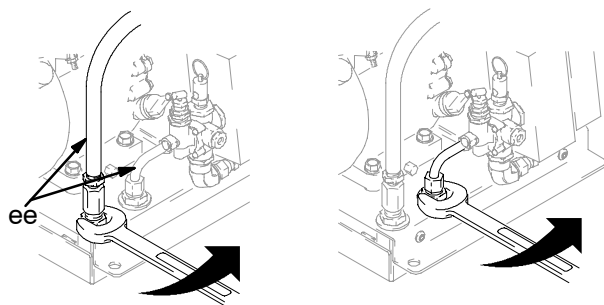

Fig. 17

**Note:** The cooler attaches to the Compressor Power Pack (Z) and the bulk head. To avoid damaging tubing, when servicing or accessing compressor, always follow steps 4 and 5 first.

5. Remove 4 set screws. Fig. 18.

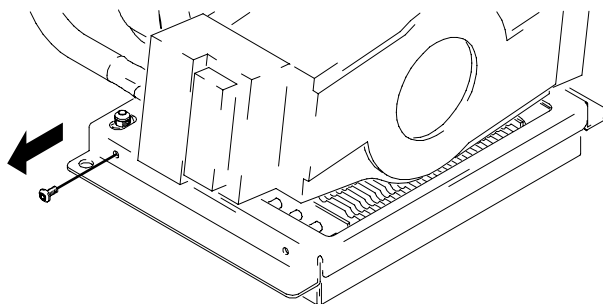

Fig. 18

6. Remove screws securing bottom to Compressor Power Pack (Z) . Separate the Compressor Power Pack (Z) from the bottom. Fig. 19.

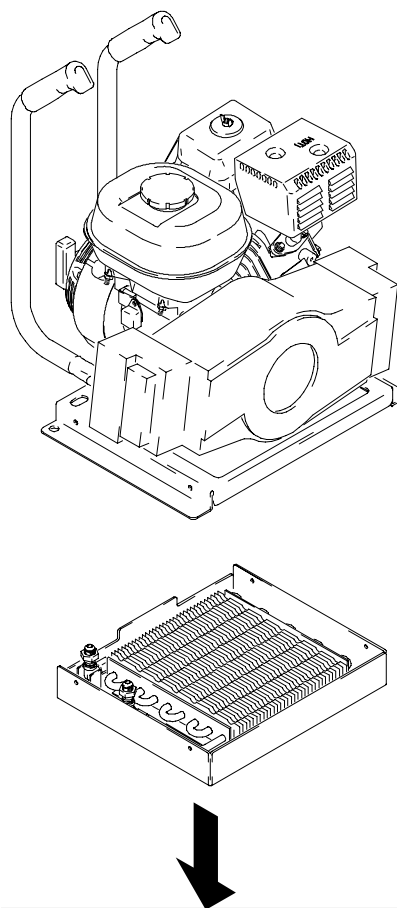
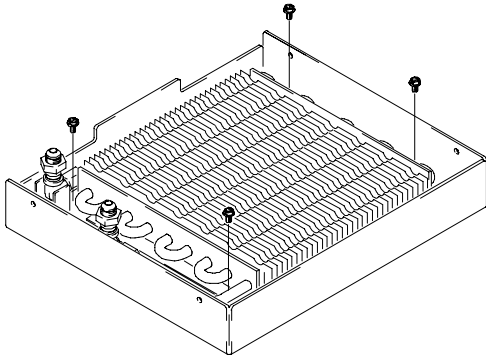

Fig. 19

# Removing and Installing Cooler

7. Remove 4 screws securing cooler in frame bottom. Fig. 20.



**Fig. 20**

8. Remove cooler from frame bottom. Fig. 21.

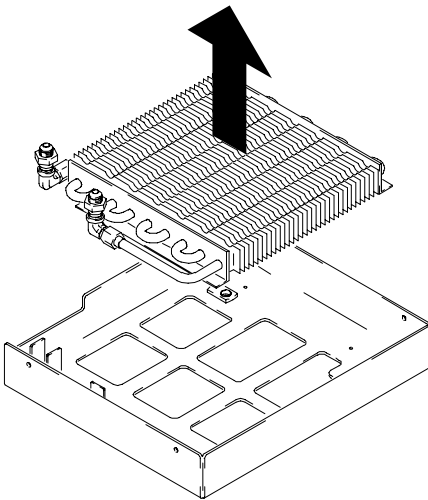

**Fig. 21**

## Installing Cooler

**NOTE:** Clean the cooler whenever the compressor is serviced.

1. Install cooler in frame bottom.
2. Replace screws.
3. Align Compressor Power Pack (Z) with frame bottom. Replace 4 screws.
4. Tighten bulk head nuts.
5. Attach air lines (ee) Fig. 17.
6. Install Compressor Power Pack (Z) on cart, page 7.

# Removing and Installing Engine

## **WARNING**



Pages 2 and 6

### Removing Engine/Compressor

1. **Relieve Pressure**, page 6.

2. Follow steps 2-5, page 13, first.
3. Remove 4 bolts holding engine to frame. Fig.22.

### Installing Engine

1. Install engine on frame.
2. Insert and tighten 4 bolts.

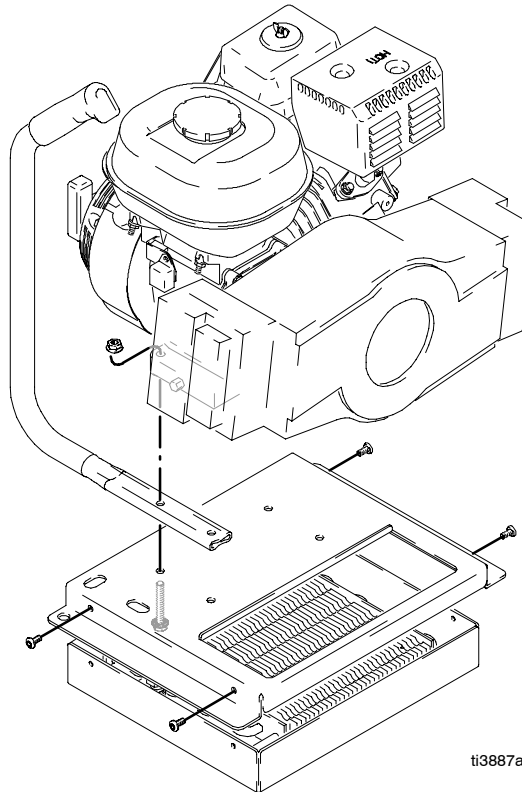

Fig. 22

# Removing and Installing Feet

## Removing Feet

**⚠ WARNING**



Page 6

1. **Relieve Pressure**, page 6.
2. Remove hopper, page 6.

3. Remove Compressor Power Pack, page 7.
4. Remove 9/16 bolt (62) and washer (66) from center of each rubber foot (8). Fig. 23.

## Installing Feet

1. Replace with new rubber foot (8) from kit.
2. Insert washer (66) and 9/16 bolt (62). Apply Locktite® to bolt threads. Tighten.

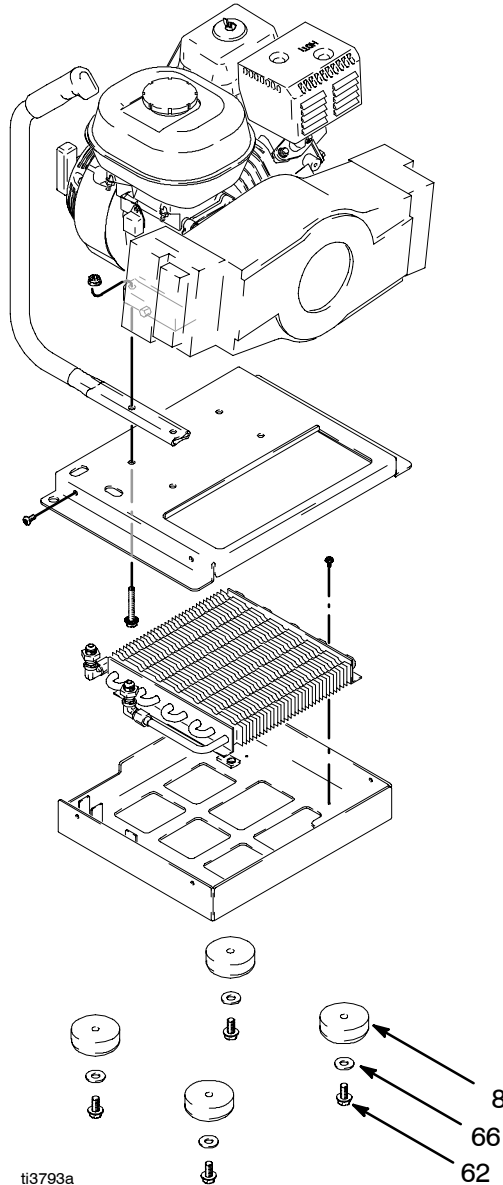

Fig. 23



# Removing and Installing Filters



## Removing Filter

1. **Relieve Pressure**, page 6.
2. Remove screws securing filter cover to compressor and remove cover. Fig. 24.

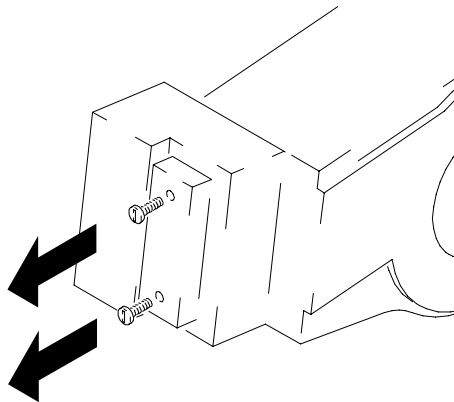

Fig. 24

3. Remove foam filter.
4. Clean filter by rinsing it thoroughly in clean water.

**Note:** Worn or damaged filter should be replaced. Use Filter Kit 118627.

## Installing Filter

1. Reinstall filter.
2. Replace cover and screws. Tighten screws.

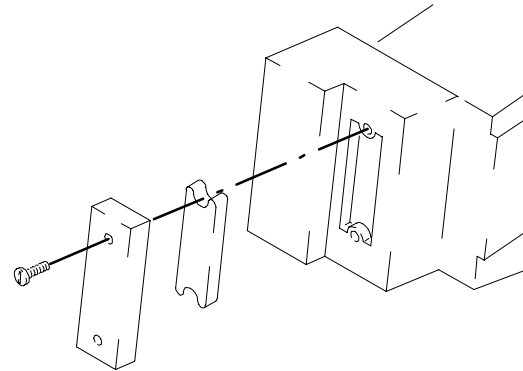

ti3781a

# Compressor Repair and Replacement



To repair compressor use Kit 118628. Refer to Thomas compressor manual provided.

To replace compressor piston assembly, use Kit 287845.

**Note:** To reduce risk of damage when installing kit 118628, **piston screws must be heated prior to removal.**

# Troubleshooting

Before performing any Troubleshooting procedures, follow **Pressure Relief Procedure** on page 6.

PROBLEM	CAUSE	SOLUTION
Compressor not building pressure or poor air flow	Open gun air valve (23)	Close valve.
	Air leak	Check all fittings and valve/regulator settings.
Unloader stuttering, unloading too early, or unloading too late.	Damaged unloader	Replace.
No material output from pump	Not enough air pressure to pump	Shut off air at the gun, and increase air pressure to the pump to maximum. Turn regulator clockwise to increase.
	Material too thick	Thin the material. Material must be mixed thoroughly to a consistency that immediately folds back in as you draw your finger through the surface of the material.
	Damaged checkballs or seats	Replace checkballs or seats.
	Plugged gun or nozzle	<b>Relieve pressure</b> , page 6. Remove gun from material hose, and cycle pump. <b>NOTE:</b> A plugged gun or nozzle may cause the hose and pump to plug. If necessary, flush hose and pump with clean water before cycling material through the hose with the gun removed.
	Plugged hose, or hose too small	<b>Relieve pressure</b> , page 6. Flush hose with clean water, or try a 1-1/4 in. hose.
Pump stops pumping	Stalled pump	Shut down system. <b>Relieve pressure</b> , page 6. Restart.
		Contact an authorized Graco service center.
Engine won't start	Engine switch is OFF	Turn engine switch ON.
	Engine is out of gas	Refill gas tank. Honda Engine Owners Manual.
	Engine oil level is low	Try to start engine. Replenish oil, if necessary. Honda Engine Owners Manual.
	Spark plug cable disconnected or damaged	Connect spark plug cable or replace spark plug.
	Cold engine	Use choke.
	Fuel shutoff lever is OFF	Move lever to ON position.
	Oil is seeping into combustion chamber	Remove spark plug. Pull starter 3 or 4 times. Clean or replace spark plug. Start engine. Keep sprayer upright to avoid oil seepage.

# Troubleshooting

Pump stops pumping	Pump in need of repair	See texture pump instruction manual 308479.
Pulsing or surging material	Triggering too fast	Slowly squeeze trigger to fully open position while moving gun quickly in a circular motion.
Speed of application too slow	Not enough air pressure to pump	Shut off air at the gun, and increase air pressure to the pump to maximum. Turn regulator clockwise to increase.
	Material too thick	Material must be mixed thoroughly to a consistency that immediately folds back in as you draw your finger through the surface of the material.
	Nozzle too small	Increase nozzle size.
	Hose plugged or too small.	<b>Relieve pressure</b> , page 6. Clean hose, or try a 1-1/4 in. hose.
	Pump in need of repair	See texture pump instruction manual 308479.
Pattern too fine or too much overspray	Material too thin	Thicken material. Material must be mixed thoroughly to a consistency that immediately folds back in as you draw your finger through the surface of the material.
	Air pressure at gun too high	Decrease air to gun at gun fitting and/or regulator.
	Fluid delivery too low	Increase nozzle size.
		Increase air pressure to pump, or decrease air to gun at gun fitting and/or regulator.
		Turn fluid knob out on gun. See <b>Spray Techniques</b> in Operation Manual 309915.
Pattern too coarse	Material too thick	Thin material. Material must be mixed thoroughly to a consistency that immediately folds back in as you draw your finger through the surface of the material.
	Air pressure at gun too low	Increase air to gun at gun fitting and/or regulator.
	Fluid delivery too high	Decrease nozzle size.
		Decrease air pressure to pump, or increase air to gun at gun fitting and/or regulator.
		Turn fluid knob in on gun. See <b>Spray Techniques</b> in Operation Manual 309915.

# Parts List

Ref No	Part No.	Description	Qty	Ref. No.	Part No.	Description	Qty.
1	116139	GRIP, handle	2	46▲	15C993	LABEL, identification	1
2	117630	SCREW, torx, tri-lobe	4	47▲	15C994	LABEL, identification	1
3	15C900	SUPPORT, motor, top	1	48▲	15C995	LABEL, warning, compressor	1
4	15C889	SUPPORT, motor, bottom	1	49▲	15C996	LABEL, warning, sprayer	1
5	15C664	COOLER, air	1	50	15C844	COVER, holder, nozzle	1
6	198693	HANDLE, slide, engine	2	51	118465	FITTING, elbow, nylon, hose	1
7	15C878	FRAME	1	52	15C948	HOSE, exhaust	1
8	801504	FOOT, rubber	6	53▲	15D089	LABEL, warning, hot	1
9	287244	KIT, hopper, texture	1	54	15D094	FILTER, hopper	1
10	116478	WHEEL, pneumatic	2	60	118591	WASHER, flat	4
11	101242	RING, retainer	2	61	114653	SCREW, cap, flange	4
12	117365	WASHER	2	62	801546	BOLT, hx, hd	2
13	246887	PUMP, diaphragm, 1040	1	63	110996	NUT, hex, flanged	8
14	246888	COMPRESSOR, air	1	64	112395	SCREW, cap	4
14a	118627	KIT, filter (contains 2 filters)	1	65	111800	SCREW, cap hex hd	5
14b	118628	KIT, compressor rebuild	1	66	100132	WASHER, flat	6
14c	287845	KIT, piston, compressor replacement	1	67	101566	NUT, lock	3
				69	112717	WASHER	1
15	118449	FITTING, elbow	2	70	100004	SCREW, cap, hex hd	1
16	15C759	COUPLING, pump	1	71	113974	SCREW mach	4
17	113696	PIN, ball, coupler	1	73	114966	KNOB, pronged	1
18	15C799	ROD, clamp	1	74	111831	SCREW, cap, skt, button hd	1
19	15C797	BRACKET, swivel	1	75	103473	STRAP, tie, wire	1
20	118436	FITTING, elbow, female	1	76	248093	GUN, model 248082	1
21	118438	REGULATOR, unloader	1		238080	GUN, flex, model 248083 (not shown)	1
22	15D011	HOSE, coupled	1		238807	GUN, pole, model 248084 (not shown)	1
23	118445	HOSE, coupled, JIC	1				
24	15D985	COUPLING	1	77	112183	PLUG	4
25	118457	GAUGE, panel, mount	2	78	15D366	PAD, isolator	1
26	118576	VALVE, safety	1	79	104430	PIN, cotter	1
27	169970	FITTING, air line	1	80	15D545	SHIELD, heat (not shown)	1
28	15B565	VALVE, ball	1	81	119063	INSULATOR, unloader, lever	1
29	104641	FITTING, bulkhead	2				
30	113029	NIPPLE, 1/4 x 1/4 NPT	1				
31	115242	REGULATOR, air, 1/4 NPT	2				
32	115244	NUT, regulator	2				
33	118486	FITTING, elbow, push	2				
34	118481	FITTING, push	2				
35	15C970	TUBE, air, pump regulator	1				
36	15C971	TUBE, air, regulator	1				
37	15C969	TUBE, air, pump	1		248112	KIT, suction - allows sprayer to pump texture material directly out of large container or trash can.	1
38	15C968	TUBE, air	2				
39	118458	FITTING, elbow, male	1		248117	HOSE, 3/8 in. x 50 ft with quick disconnect - allows compressor to stay outside while sprayer is used inside. Can use up to three (3), 50 ft sections with minimal performance loss.	1
40	118482	FITTING, elbow, 45°	1				
41	118472	FITTING, tee	1				
42	118484	FITTING, connector	2				
43	116720	COUPLER, air, quick disconnect	1				
44	287304	HOSE SET, twin line, (1 in. x 25 ft)	1				
45▲	15C992	LABEL, hopper	1				

▲ Replacement Danger and Warning labels, tags and cards are available at no cost.

## Accessories

# Parts Drawing

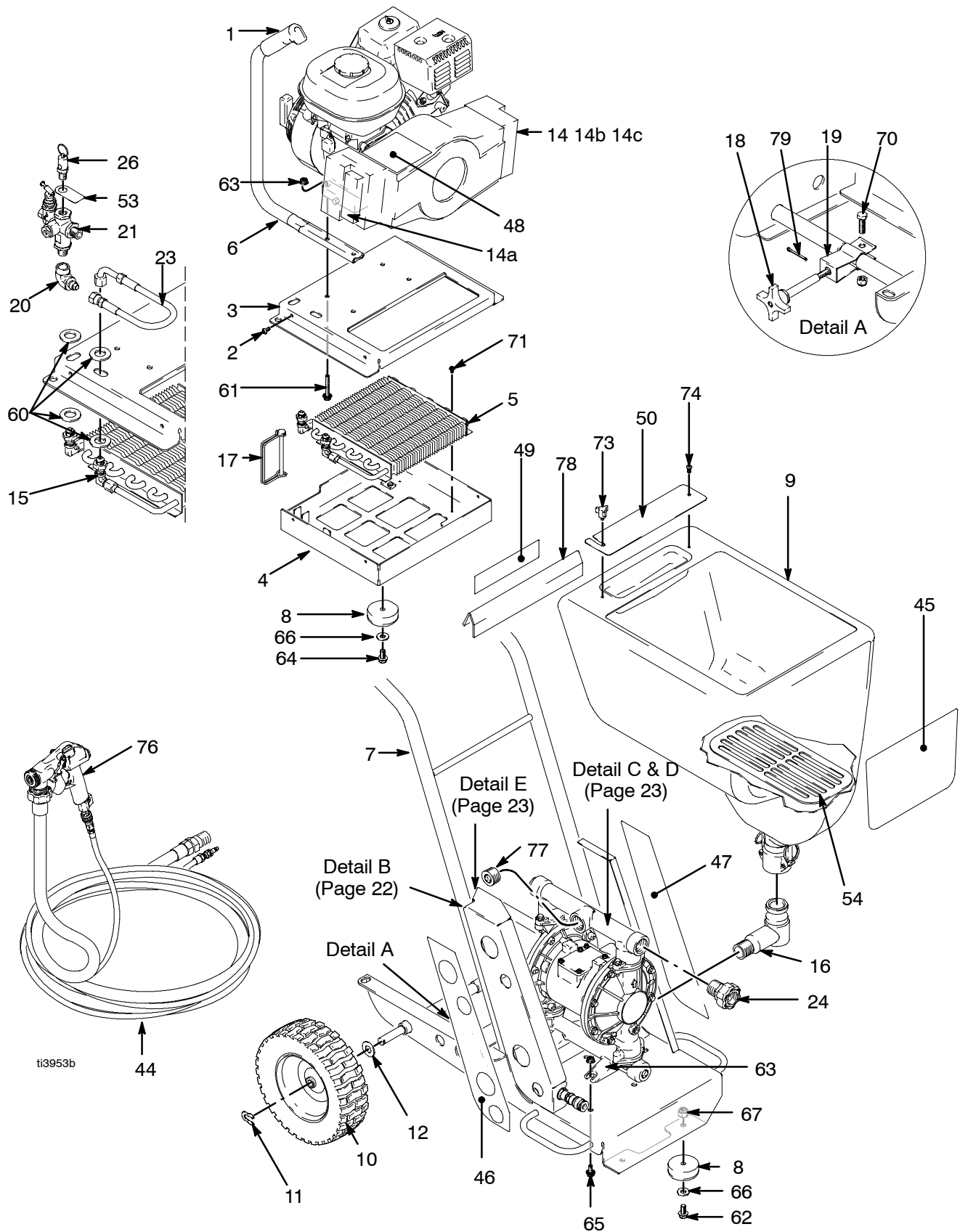

# Parts Drawing

## Detail B Air Line Components

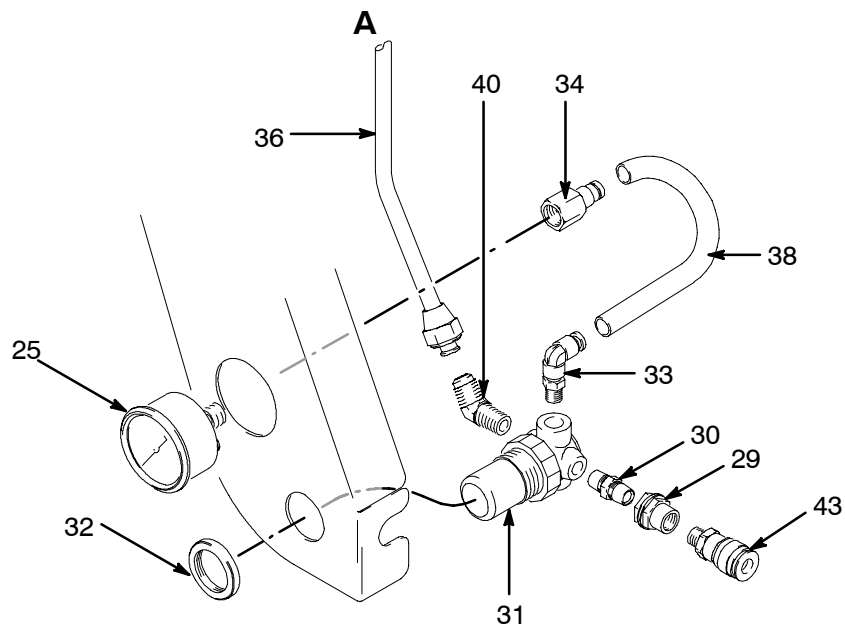
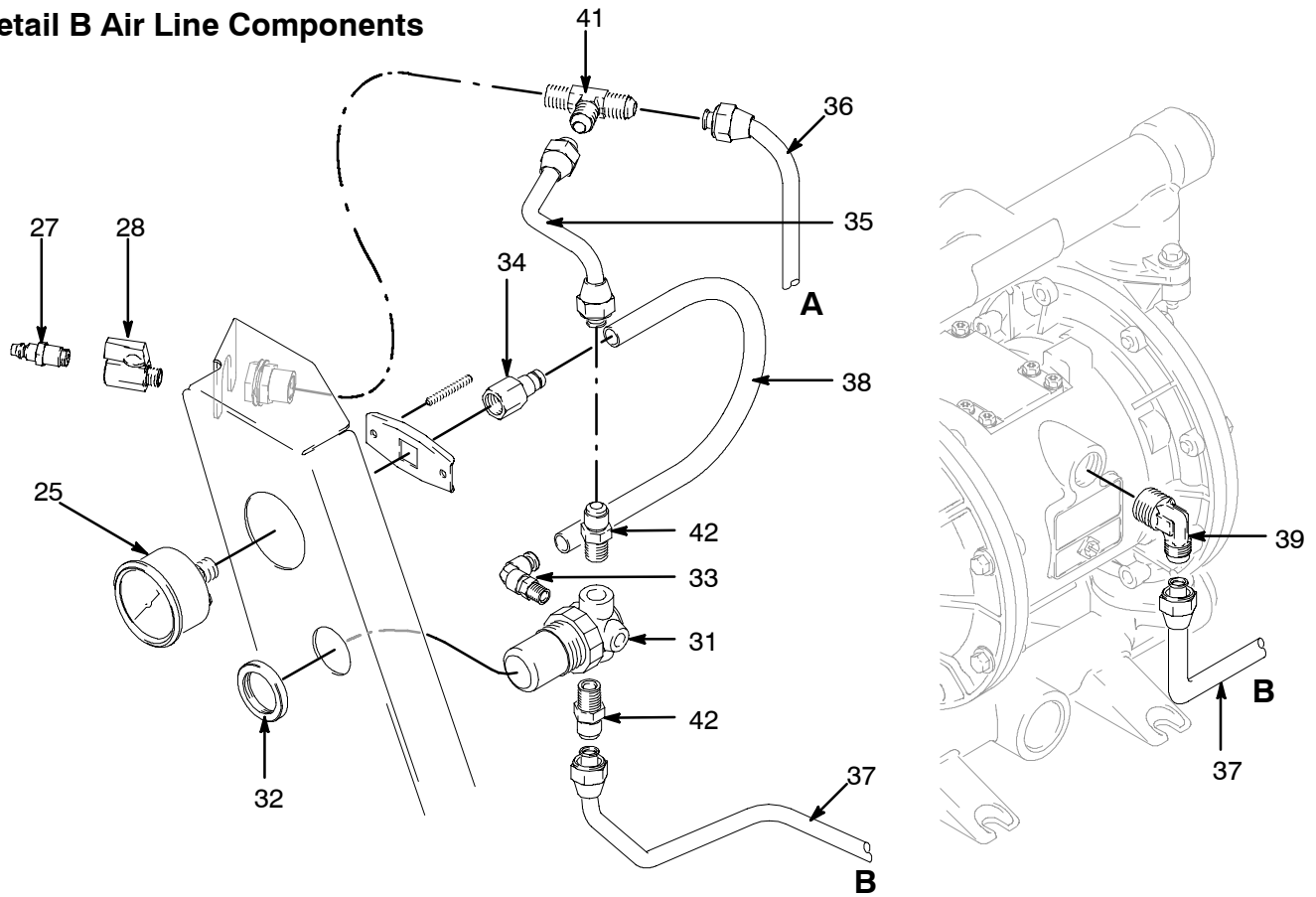

# Parts Drawing

## Detail C Pump Elbow Connections

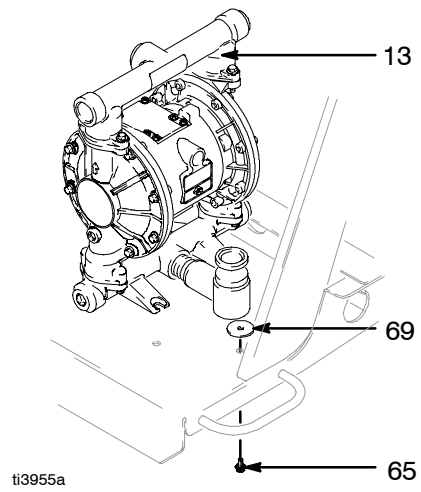

## Detail D Exhaust Pipe and Connector

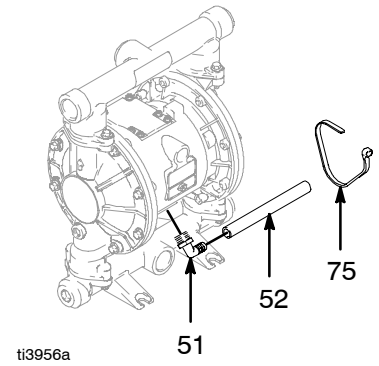

## Detail E Air Line Connection

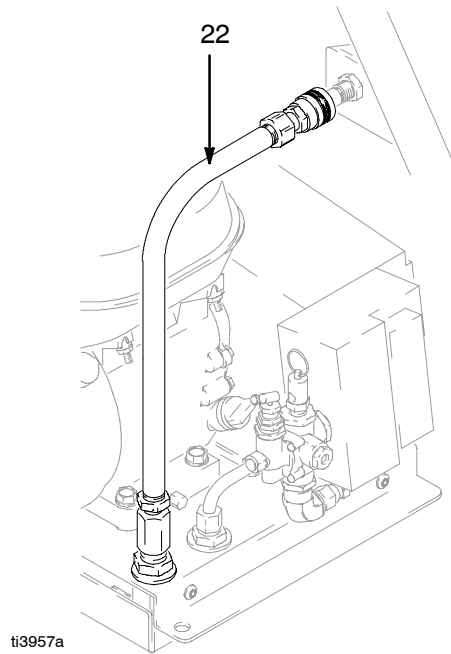

# Pump Parts List

Ref No	Part No.	Description	Qty	Ref. No.	Part No.	Description	Qty.
1	188838	HOUSING, center, aluminum	1	103	188842	MANIFOLD, outlet, aluminum	1
2	188854	COVER, air valve, aluminum	1	104	188607	PLATE, air side, aluminum	2
3	116344	SCREW, mach, hex flange hd; M5 X 0.8; 12 mm (0.47 in.)	9	105	188607	PLATE, fluid side, aluminum	2
4	188618	GASKET, molded Santoprene	1	106	115643	SCREW, M8 X 1.25; 25 mm (1 in.)	24
5	188855	CARRIAGE, aluminum	1	107	189044	BOLT, M12 X 1.75; 35 mm (1.38 in.) sst	2
6†	108730	O-RING, nitrile	1	108*	104319	O-RING, PTFE	2
7†	188616	BLOCK, air valve, acetal	1	110▲	188621	LABEL, warning	1
8	188615	PLATE, air valve, sst	1	113	112183	PLUG, 1 in. npt, cst	4
9†	188617	SEAL, valve plate, buna-N	1	201*	194211	SEAT, Geolast®	4
10†	112181	PACKING, u-cup, nitrile	2	202*	109205	O-RING, PTFE	8
11	188612	PISTON, actuator, acetal	2	301*	114751	BALL, Geolast® 1-1/4 in.	4
12	188613	BEARING, piston, acetal	2		287272	KIT, Ball, 1-1/8 in. (used to reduce packout with thicker materials)	
15	188611	BEARING, pin, acetal	2	401*	15B499	DIAPHRAGM, buna-N	2
16	188610	PIN, pilot, stainless steel	2	402*	112181	PACKING, u-cup, nitrile	2
17†	157628	O-RING, buna-N	2	† These parts are included in Air Valve Repair Kit 236273, which may be purchased separately.			
18†	188614	BLOCK, pilot, acetal	1				
19	188609	BEARING, shaft, acetal	2	* These parts are included in Pump Repair Kit D07GG7 which may be purchased separately.			
20	116343	SCREW, grounding	1				
22	188603	GASKET, air cover, foam	2	▲ Replacement Danger and Warning labels, tags and cards are available at no cost.			
23	188839	COVER, air, aluminum	2				
24	188608	SHAFT, diaphragm, sst	1				
25	115643	SCREW, M8 X 1.25; 25 mm (1 in.)	12				
101	188840	COVER, fluid, aluminum	2				
102	188841	MANIFOLD, inlet, aluminum	1				



This exploded view diagram illustrates the assembly of a vehicle wheel. The components are identified by the following callouts:

- Top Section (Hub and Bearings):** Includes parts 3, 2, 4†, 11, 10†, 5, 6†, 7†, 8, 9†, 16, 17†, 18, and 20.
- Wheel Rim and Disc:** Includes parts 1, 15, 19, 12, 10†, 11, 22, 23, 25, 24, and 104.
- Upper Suspension Arm Assembly:** Includes parts 110, 113, 106, 103, 301\*, 202\*4, 201\*, and 108\*.
- Lower Suspension Arm Assembly:** Includes parts 101, 102, 106, 113, 301, 202\*4, and 201.
- Fasteners:** Various screws and bolts are indicated by callouts such as †17, †18, †19, †20, †21, †22, †23, †24, †25, †26, †27, †28, †29, †30, †31, †32, †33, †34, †35, †36, †37, †38, †39, †40, †41, †42, †43, †44, †45, †46, †47, †48, †49, †50, †51, †52, †53, †54, †55, †56, †57, †58, †59, †60, †61, †62, †63, †64, †65, †66, †67, †68, †69, †70, †71, †72, †73, †74, †75, †76, †77, †78, †79, †80, †81, †82, †83, †84, †85, †86, †87, †88, †89, †90, †91, †92, †93, †94, †95, †96, †97, †98, †99, †100, †101, †102, †103, †104, †105, †106, †107, †108, †109, †110, †111, †112, †113, †114, †115, †116, †117, †118, †119, †120, †121, †122, †123, †124, †125, †126, †127, †128, †129, †130, †131, †132, †133, †134, †135, †136, †137, †138, †139, †140, †141, †142, †143, †144, †145, †146, †147, †148, †149, †150, †151, †152, †153, †154, †155, †156, †157, †158, †159, †160, †161, †162, †163, †164, †165, †166, †167, †168, †169, †170, †171, †172, †173, †174, †175, †176, †177, †178, †179, †180, †181, †182, †183, †184, †185, †186, †187, †188, †189, †190, †191, †192, †193, †194, †195, †196, †197, †198, †199, †200, †201, †202, †203, †204, †205, †206, †207, †208, †209, †210, †211, †212, †213, †214, †215, †216, †217, †218, †219, †220, †221, †222, †223, †224, †225, †226, †227, †228, †229, †230, †231, †232, †233, †234, †235, †236, †237, †238, †239, †240, †241, †242, †243, †244, †245, †246, †247, †248, †249, †250, †251, †252, †253, †254, †255, †256, †257, †258, †259, †260, †261, †262, †263, †264, †265, †266, †267, †268, †269, †270, †271, †272, †273, †274, †275, †276, †277, †278, †279, †280, †281, †282, †283, †284, †285, †286, †287, †288, †289, †290, †291, †292, †293, †294, †295, †296, †297, †298, †299, †300, †301, †302, †303, †304, †305, †306, †307, †308, †309, †310, †311, †312, †313, †314, †315, †316, †317, †318, †319, †320, †321, †322, †323, †324, †325, †326, †327, †328, †329, †330, †331, †332, †333, †334, †335, †336, †337, †338, †339, †340, †341, †342, †343, †344, †345, †346, †347, †348, †349, †350, †351, †352, †353, †354, †355, †356, †357, †358, †359, †360, †361, †362, †363, †364, †365, †366, †367, †368, †369, †370, †371, †372, †373, †374, †375, †376, †377, †378, †379, †380, †381, †382, †383, †384, †385, †386, †387, †388, †389, †390, †391, †392, †393, †394, †395, †396, †397, †398, †399, †400, †401, †402, †403, †404, †405, †406, †407, †408, †409, †410, †411, †412, †413, †414, †415, †416, †417, †418, †419, †420, †421, †422, †423, †424, †425, †426, †427, †428, †429, †430, †431, †432, †433, †434, †435, †436, †437, †438, †439, †440, †441, †442, †443, †444, †445, †446, †447, †448, †449, †450, †451, †452, †453, †454, †455, †456, †457, †458, †459, †460, †461, †462, †463, †464, †465, †466, †467, †468, †469, †470, †471, †472, †473, †474, †475, †476, †477, †478, †479, †480, †481, †482, †483, †484, †485, †486, †487, †488, †489, †490, †491, †492, †493, †494, †495, †496, †497, †498, †499, †500, †501, †502, †503, †504, †505, †506, †507, †508, †509, †510, †511, †512, †513, †514, †515, †516, †517, †518, †519, †520, †521, †522, †523, †524, †525, †526, †527, †528, †529, †530, †531, †532, †533, †534, †535, †536, †537, †538, †539, †540, †541, †542, †543, †544, †545, †546, †547, †548, †549, †550, †551, †552, †553, †554, †555, †556, †557, †558, †559, †560, †561, †562, †563, †564, †565, †566, †567, †568, †569, †570, †571, †572, †573, †574, †575, †576, †577, †578, †579, †580, †581, †582, †583, †584, †585, †586, †587, †588, †589, †590, †591, †592, †593, †594, †595, †596, †597, †598, †599, †600, †601, †602, †603, †604, †605, †606, †607, †608, †609, †610, †611, †612, †613, †614, †615, †616, †617, †618, †619, †620, †621, †622, †623, †624, †625, †626, †627, †628, †629, †630, †631, †632, †633, †634, †635, †636, †637, †638, †639, †640, †641, †642, †643, †644, †645, †646, †647, †648, †649, †650, †651, †652, †653, †654, †655, †656, †657, †658, †6

# Technical Data

Maximum air working pressure ..... 120 psi (8.27 bar)  
Maximum working fluid pressure .... 120 psi (8.27 bar)  
Air pressure operating range ..... 25 to 120 psi  
(1.7 to 8.27 bar)  
Compressor specifications ..... oil-less compressor  
    Air Displacement               24 cfm (680 lpm)  
    Air Delivery                   12 cfm @ 100 psi  
                                     (340 lpm @ 6.9 bar)  
Engine                               5.5 HP Honda OHV  
    Gas Capacity                 0.95 US gallon (3.6 liters)  
    Oil Capacity                 0.63 US quart (0.60 liter)  
Hopper capacity  
    Maximum ..... 17 gallons (64 liters)

Maximum delivery with texture material ..... 4.0 gpm  
(15.14 lpm)  
Maximum delivery with water ... 40.0 gpm (151.4 lpm)  
Dimensions  
    Length ..... 38 in. (965 mm) with handle  
    Width ..... 24 in. (610 mm)  
    Height ..... 40 in. (1016 mm)  
Weight  
    With hoses and gun ..... 185 lb (83.91 kg)  
    Without hoses and gun ..... 165 lb (74.84 kg)  
    Without hoses, gun and compressor power pack  
    ..... 90 lb (40.82 kg)  
    Compressor power pack only       75 lb (34.02 kg)  
Wetted parts ..... PVC, zinc plate CS,  
                                     buna-N, aluminum, brass, polyethylene  
                                     sst, UHMW, acetal  
Sound data  
    Sound pressure level \* ..... 92.2 dB(A)  
    Sound power level † ..... 106.3 dB(A)  
    \* Measured while spraying at 1 m.  
    † Measured per ISO-3744.

[illegible]

# Graco Warranty

Graco warrants all equipment manufactured by Graco and bearing its name to be free from defects in material and workmanship on the date of sale to the original purchaser for use. With the exception of any special, extended, or limited warranty published by Graco, Graco will, for a period of twelve months from the date of sale, repair or replace any part of the equipment determined by Graco to be defective. This warranty applies only when the equipment is installed, operated and maintained in accordance with Graco's written recommendations.

This warranty does not cover, and Graco shall not be liable for general wear and tear, or any malfunction, damage or wear caused by faulty installation, misapplication, abrasion, corrosion, inadequate or improper maintenance, negligence, accident, tampering, or substitution of non-Graco component parts. Nor shall Graco be liable for malfunction, damage or wear caused by the incompatibility of Graco equipment with structures, accessories, equipment or materials not supplied by Graco, or the improper design, manufacture, installation, operation or maintenance of structures, accessories, equipment or materials not supplied by Graco.

This warranty is conditioned upon the prepaid return of the equipment claimed to be defective to an authorized Graco distributor for verification of the claimed defect. If the claimed defect is verified, Graco will repair or replace free of charge any defective parts. The equipment will be returned to the original purchaser transportation prepaid. If inspection of the equipment does not disclose any defect in material or workmanship, repairs will be made at a reasonable charge, which charges may include the costs of parts, labor, and transportation.

**THIS WARRANTY IS EXCLUSIVE, AND IS IN LIEU OF ANY OTHER WARRANTIES, EXPRESS OR IMPLIED, INCLUDING BUT NOT LIMITED TO WARRANTY OF MERCHANTABILITY OR WARRANTY OF FITNESS FOR A PARTICULAR PURPOSE.**

Graco's sole obligation and buyer's sole remedy for any breach of warranty shall be as set forth above. The buyer agrees that no other remedy (including, but not limited to, incidental or consequential damages for lost profits, lost sales, injury to person or property, or any other incidental or consequential loss) shall be available. Any action for breach of warranty must be brought within two (2) years of the date of sale.

Graco makes no warranty, and disclaims all implied warranties of merchantability and fitness for a particular purpose in connection with accessories, equipment, materials or components sold but not manufactured by Graco. These items sold, but not manufactured by Graco (such as electric motors, switches, hose, etc.), are subject to the warranty, if any, of their manufacturer. Graco will provide purchaser with reasonable assistance in making any claim for breach of these warranties.

In no event will Graco be liable for indirect, incidental, special or consequential damages resulting from Graco supplying equipment hereunder, or the furnishing, performance, or use of any products or other goods sold hereto, whether due to a breach of contract, breach of warranty, the negligence of Graco, or otherwise.

## **FOR GRACO CANADA CUSTOMERS**

The parties acknowledge that they have required that the present document, as well as all documents, notices and legal proceedings entered into, given or instituted pursuant hereto or relating directly or indirectly hereto, be drawn up in English. Les parties reconnaissent avoir convenu que la rédaction du présent document sera en Anglais, ainsi que tous documents, avis et procédures judiciaires exécutés, donnés ou intentés à la suite de ou en rapport, directement ou indirectement, avec les procédures concernées.

## **ADDITIONAL WARRANTY COVERAGE**

Graco does provide extended warranty and wear warranty for products described in the "Graco Contractor Equipment Warranty Program".

# Graco Phone Number

**TO PLACE AN ORDER**, contact your Graco distributor, or call this number to identify the distributor closest to you:  
**1-800-690-2894 Toll Free**

*All written and visual data contained in this document reflect the latest product information available at the time of publication.  
Graco reserves the right to make changes at any time without notice.*

MM 309916

*This manual contains English*

**Graco Headquarters:** Minneapolis  
**International Offices:** Belgium, China, Japan, Korea

**GRACO INC. P.O. BOX 1441 MINNEAPOLIS, MN 55440-1441**

**<http://www.graco.com>**

Written in USA 10/2003, Rev 08/2009